

MODEL - D

Direct drive forward curved blower

Blower	Wheel	Bore	A	B	C	D	E	F	G	H
D06AA	6¼ x 3	5⁄₈	9¾	8	7¾	4¼	4¼	7	½	5
D06AB	6¼ x 3	5⁄₈	9¾	8	7¾	4¼	4¼	7	½	5
D08A	7¾ x 3⅜	5⁄₈	11	8	8¼	5⅜	5	7	½	6
D08C	7¾ x 3⅜	5⁄₈	11	8	8¼	5⅜	5	7	½	6
D09C	9 x 4½	5⁄₈	12⅝	8	10¾	6½	5⅝	7	½	6¾
D09F	9 x 4½	5⁄₈	12⅝	8	10¾	6½	5⅝	7	½	6¾
D11E	10⅝ x 5¼	5⁄₈	14¾	11½	11¾	8	6⅞	10	¾	8
D11G	10⅝	5⁄₈	14¾	11½	11¾	5⅞	6⅞	10	¾	8

Blower	J	K	L	M*	O	P	R	X
D06AA	4	6	5	11⅝	3⅜	6	7⅞	9
D06AB	4	6	5	11⅝	3⅜	6	7⅞	9
D08A	4⅝	6¾	6⅞	12¼	3¾	8	8	9
D08C	4⅝	6¾	6⅞	12¼	3¾	8	8	9
D09C	5⅝	7¾	7⅞	13	4⅜	9	9¼	9⅞
D09F	5⅝	7¾	7⅞	14¼	4⅜	9	9¼	9⅞
D11E	6¾	9⅞	8⅞	15½	5	10	10¾	11¼
D11G	6¾	9⅞	8⅞	14⅝	4	10	10¾	11¼

* Dimension may vary depending on type of motor used.

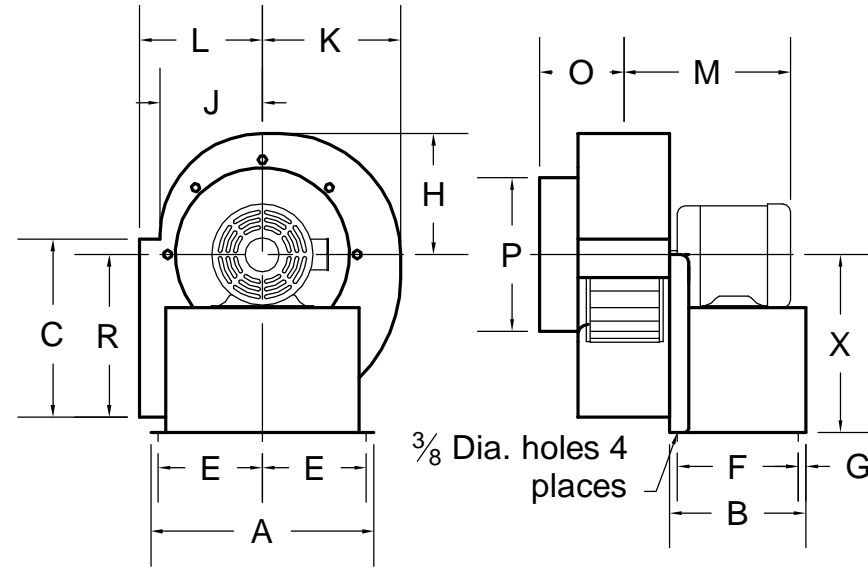

Standard Features

- Forward curved steel wheel, dynamically balanced
- Welded 16 gauge steel housings and motor base painted
- Bottom horizontal discharge
- Clockwise rotation
- TEFC motors
- Factory assembled

Accessories

- A - Disconnect switch
- B - Galvanized motor weather cover
- C - Shaft seal
- D - Aluminum backdraft damper