

# 700 SERIES DIMENSIONS

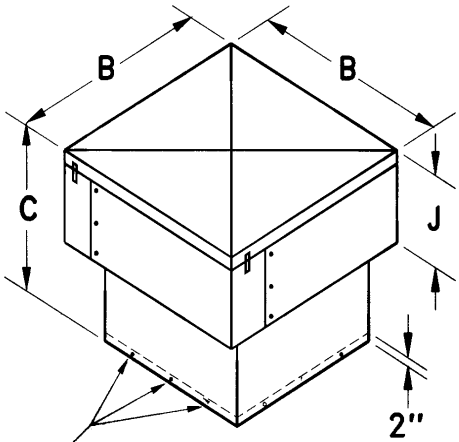

5/16" HOLES FOR FASTENING TO CURB

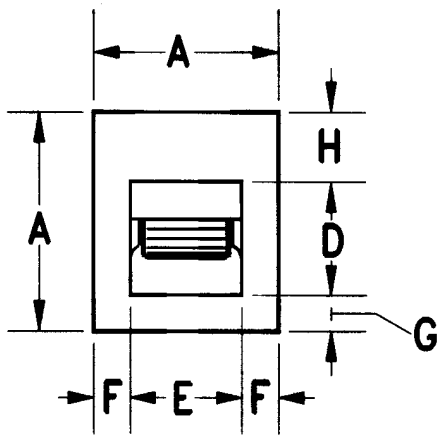

BOTTOM VIEW

DIMENSIONS (inches)

NOTE: WT. SHOWN IS LESS MOTOR AND DRIVE

MODEL	A	B	C	D	E	F	G	H	J	FILTERS	* INSIDE CABINET	UNIT WT. (LBS.)
709	24-3/8	32-3/8	24-3/8	10-1/4	11-13/16	6-9/32	7-1/16	7-1/16	10-1/4	4-10x20	24x24	84
710	28-3/8	38-1/2	28-1/4	11-3/8	13-1/8	7-5/8	8-1/2	8-1/2	12-1/4	4-12x24	28x28	108
712	32-3/8	42-5/8	31-3/8	13-7/16	15-5/8	8-3/8	9-15/32	9-15/32	16-1/2	4x16x25	32x32	150
715	32-3/8	42-5/8	31-3/8	15-7/8	18-5/8	6-7/8	6-1/4	10-1/4	16-1/2	4x16x25	32x32	155
718	36-3/8	48-5/16	37-1/4	18-7/8	21-7/8	7-1/4	6	11-1/2	20-3/4	4-20x28-1/2	36x36	245

\* CURB SIZE TO BE SMALLER THAN INSIDE CABINET SIZE TO ALLOW FOR FLASHING AND ROOFING.





# 700 SERIES BLOWERS

# SUBMITTAL DRAWING

- BALL BEARINGS
- PERMANENT WASHABLE FILTERS
- INSULATED TOP
- WEATHER RESISTANT ENAMEL PAINT FINISH ON GALVANIZED STEEL
- QUIET FORWARD CURVED BLOWER
- LATCHED TOP COVER

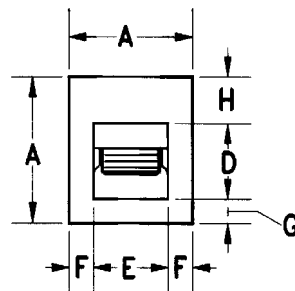
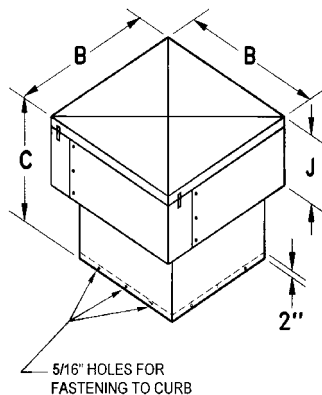

BOTTOM VIEW

## DIMENSIONS (inches)

MODEL	A	B	C	D	E	F	G	H	J	FILTERS	* INSIDE CABINET	UNIT WT. (LBS.)		
<b>709</b>	24-3/8	32-3/8	24-3/8	10-1/4	11-13/16	6-9/32	7-1/16	7-1/16	10-1/4	4-10x20	24x24	84		
<b>710</b>	28-3/8	38-1/2	28-1/4	11-3/8	13-1/8	7-5/8	8-1/2	8-1/2	12-1/4	4-12x24	28x28	108		
<b>712</b>	32-3/8	42-5/8	31-3/8	13-7/16	15-5/8	8-3/8	9-15/32	9-15/32	16-1/2	4x16x25	32x32	150		
<b>715</b>	32-3/8	42-5/8	31-3/8	15-7/8	18-5/8	6-7/8	6-1/4	10-1/4	16-1/2	4x16x25	32x32	155		
<b>718</b>	36-3/8	48-5/16	37-1/4	18-7/8	21-7/8	7-1/4	6	11-1/2	20-3/4	4-20x28-1/2	36x36	245		

\* CURB SIZE TO BE SMALLER THAN INSIDE CABINET SIZE TO ALLOW FOR FLASHING AND ROOFING

NOTE: WT. SHOWN IS LESS MOTOR AND DRIVE